

3-pole

Technical data

Motor starter for direct on-line starting with thermal release 4 kW

Marking to 94/9/EC	Ⓔ II 2 G Ex de IIC / Ⓔ I M 2 Ex de I	
EC Type Examination Certificate	PTB 98 ATEX 1087 U	
IECEX Certificate of Conformity	IECEX BK1 07.0038 U	
Marking accd. to IECEX	Ex de IIC	
Application temperature ¹⁾	-20 °C to +40 °C	
Rated voltage	Main contact	max. 690 V/AC / 50-60 Hz
	Control contact A1-A2	12 V to 690 V/AC / 12 V bis 230 V/DC
Rated current	Main contact	max. 20 A
	Auxiliary contact	max. 6 A
Rated making-/rated breaking capacity accd. to EN 60947-4-1 AC-3	U _e 230 V / P _e 2,2 KW	
	U _e 400 V / P _e 4 KW	
	U _e 690 V / P _e 4 KW	
Rated making-/rated breaking capacity auxiliary contact accd. to EN 60947-4-1 AC-15	U _e 230 V / I _e 4 A	
Back-up fuse	20 A gL	
Terminal cross-section	Main contact	2 x 10 mm ² fine wire with wire end sleeve/single wire
	Auxiliary contact/ Control contact A1-A2	2 x 2.5 mm ² fine wire with wire end sleeve/single wire
	Signal contact	2 x 2.5 mm ² fine wire with wire end sleeve/single wire
Weight	1.72 kg size 3	
Enclosure material	Glass-fibre reinforced polyester	
Enclosure colour	black	
Options	Auxiliary contact	

¹⁾ Depend on installation

| Ex-Built-in components |

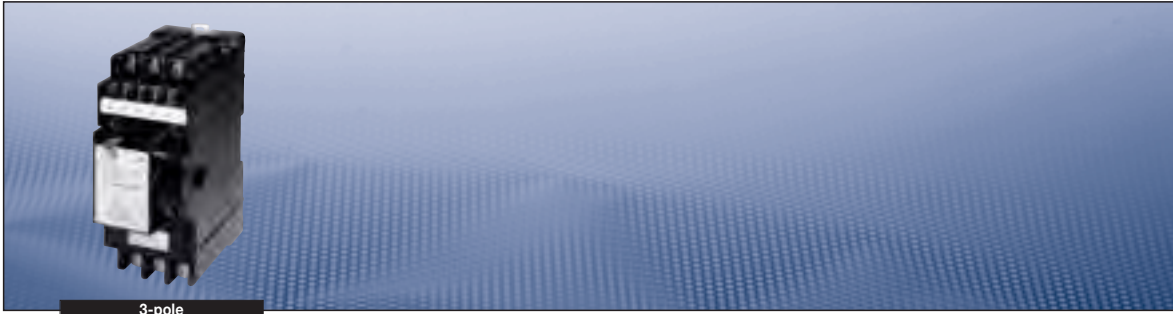

3-pole

Ex-Built-in components

Motor starter for direct on-line starting with thermal release 4 kW

GHG 618 3102 RXXYY

1. Rated current

2. Coil voltage

Ordering details Type: 3-pole

1. Rated current	XX	2. Contact voltage A1-A2	YY
Module size 3 (70 mm)			
0.11 A - 0.16 A	01	110 V AC	04
0.16 A - 0.23 A	02	230 V AC	05
0.23 A - 0.36 A	03	240 V AC	06
0.36 A - 0.54 A	04	120 V AC	07
0.54 A - 0.80 A	05	400 V AC	08
0.80 A - 1.20 A	06	440 V AC	09
1.20 A - 1.8 A	07	380 / 400 V AC	10
1.8 A - 2.6 A	08	24 V DC	32
2.6 A - 3.7 A	09	48 V DC	34
3.7 A - 5.5 A	10	110 V DC	36
5.5 A - 8.0 A	11		
8.0 A - 11.5 A	12		

Example

GHG 618 3102 RXXYY

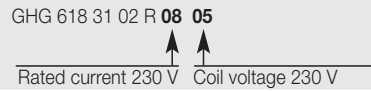

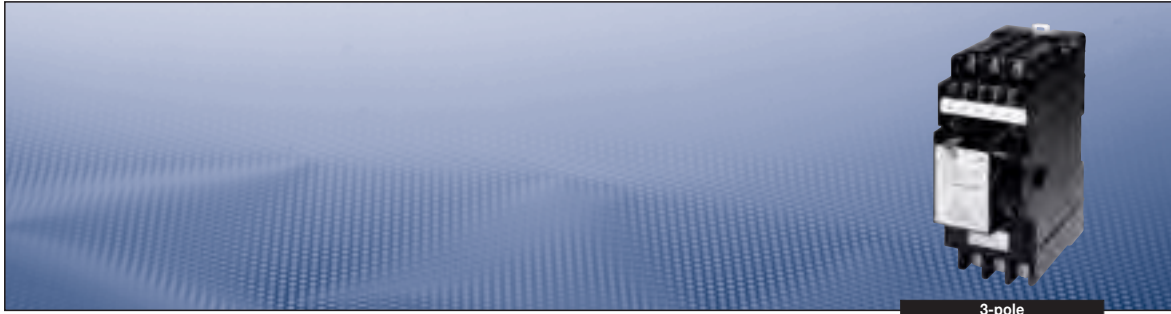

3-pole

Dimension drawing | Main contacts

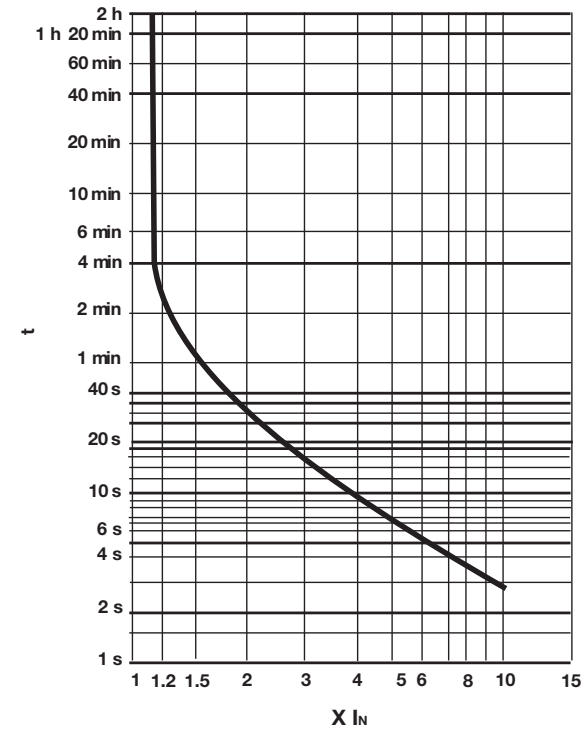
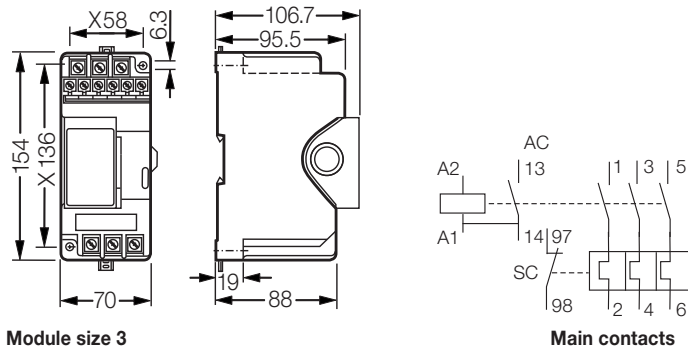

AC = Auxiliary contact
 SC = Signal contact

Dimensions in mm